

# MONTERINGSANVISNING CASTOR INSTALLATION INSTRUCTION CASTOR

1

För utanpåliggande montage gå direkt till steg 3.  
For mounting with external cable go to step 3.

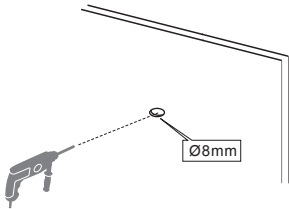

1.0 Borra ett Ø8mm hål vid fast installation.  
1.0 Drill the Ø8mm hole for fixed installation.

2

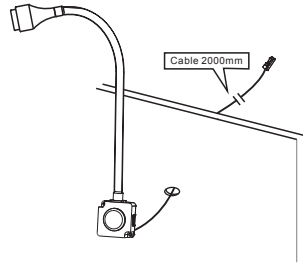

2.0 För kabeln genom hålet.  
2.0 Pass the cable through the hole.

3

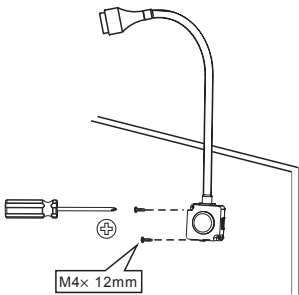

3.0 Montera armaturen.  
3.0 Fix the light.

4

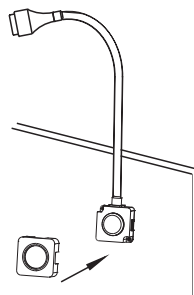

4.0 Montera täcklocket.  
4.0 Fix the cover.

5

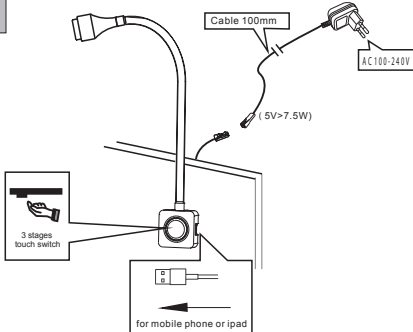

Avinstallation - Uninstallation

6

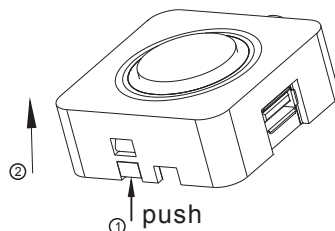

6.0 Tryck in spärren och ta av täcklocket.  
6.0 Push the dip and take out the cover.

L=mm	W	VDC
543	2.0	5